

### 「3.23 民間全民投票計劃」之操作構思

#### 網上投票

投票時間：零晨零時 至 晚上八時正

網址：「PopVote 普及投票」(popvote.hk)

認證資料：投票人士身份證全部號碼，及可發送短訊（SMS）之手機號碼

#### 網上投票流程



投票流程：

- 1) 擬投票人士須登入「PopVote 普及投票」網站
- 2) 確認自己年滿 18 歲，及屬於香港永久居民，然後輸入身份證全部號碼，及可發送短訊(SMS)之手機號碼
- 3) 於 1 分鐘內以先前輸入的手機，按照指示發送一個空白或有任何字句的短訊至系統顯示的電話號碼
- 4) 系統在接收有關短訊後，會開啟投票界面予該名人士投票。倘若系統發現有關人士的身份證或手機號碼已經重複使用，系統將不會容許有關人士進入投票界面
- 5) 投票人士按照個人意願，於 3 分鐘內，選擇其中一位候選人或選擇棄權，然後將電子投票表格送出

資料保障措施：

- 1) 投票系統會將身份證全部號碼及手機號碼化成一組不能還原的散列函數（Hash Code）儲存，以保護登記人士的私隱，及防止重複投票
- 2) 網站已獲取香港郵政電子證書，以防止網站被偽冒，及確保資料於傳輸時已作加密處理
- 3) 登記電腦所使用的系統將配備虛擬鍵盤，以防止資料被盜取
- 4) 由於沒有資料儲存於電腦，若於未完成投票前離開投票介面，擬投票人士須重覆所有步驟
- 5) 所有資料經處理後儲存於中央伺服器，電腦不會有任何個人資料記錄

### **流動應用程式(Smartphone App)投票**

投票時間及流程與網上投票相同，唯流動應用程式投票須下載「PopVote」應用程式。

### 票站投票

票站場地初步設計：

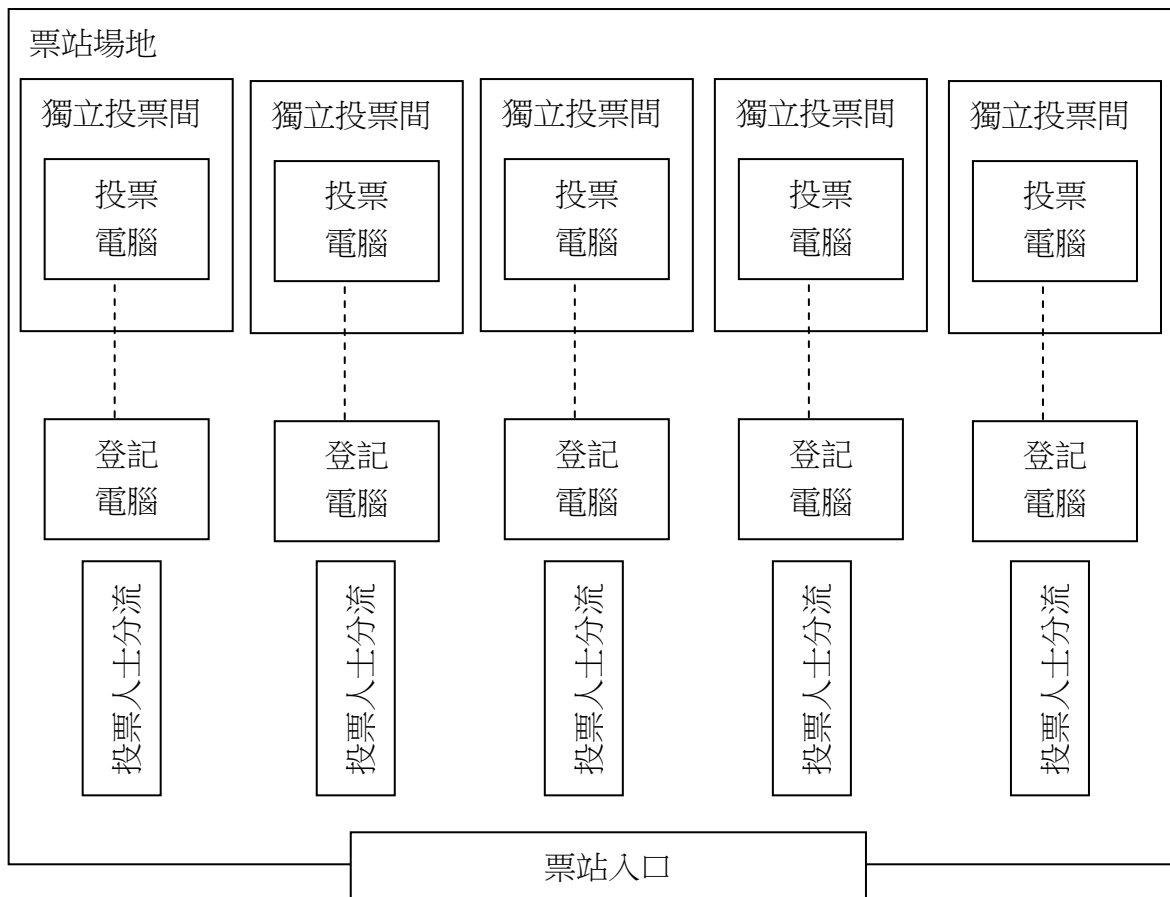

投票時間：上午九時正 至 下午九時正

電腦數目：約 10 部

票站工作人員：約 12 位

票站數目及地點：待定

認證資料：身份證

## 票站投票流程



### 投票流程：

- 1) 按指引到登記電腦前排隊
- 2) 展示身份證給負責操作登記電腦的工作人員
- 3) 該工作人員會核實持證人士身份，然後將身份證全部號碼輸入電腦，然後安排投票人士到指定的獨立投票間
- 4) 進入投票間後，投票電腦會自動啟動，毋須入任何個人資料。投票人士只須按照個人意願，於3分鐘內，選擇其中一位候選人或選擇棄權，然後將電子投票表格送出
- 5) 投票間附近將有工作人員協助有需要人士

### 資料保障措施：

- 1) 採用私隱程度高的獨立投票間，投票期間不受干擾
- 2) 工作人員只會輸入投票人士的身份證號碼到投票系統
- 3) 投票系統會將身份證全部號碼化成一組不能還原的散列函數（Hash Code）儲存，以保護登記人士的私隱，及防止重複投票
- 4) 登記電腦所使用的系統將配備虛擬鍵盤，以防止資料被盜取
- 5) 網站已獲取香港郵政電子證書，以防止網站被偽冒，及確保資料於傳輸時已作加密處理
- 6) 所有資料經處理後儲存於中央伺服器，電腦不會有任何個人資料記錄

## “3.23 Civil Referendum Project” Operation Plan

### Offsite e-polling

Voting time: 0000 to 2000

Website: PopVote (<http://popvote.hk>)

Information for verification: Identity Card Number in full of the voter and a cell phone number which can be used to send SMS

### Offsite e-polling Process

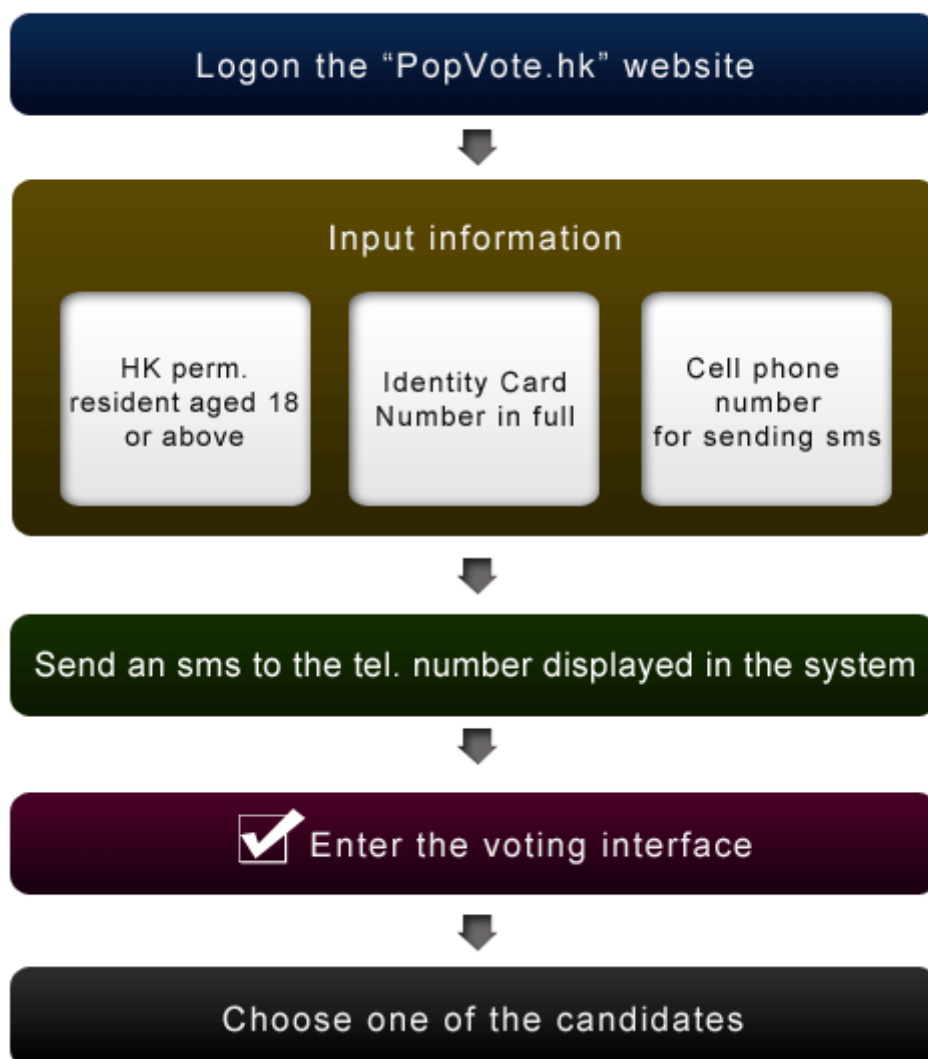

Voting procedures :

- 1) Intending voters must logon the PopVote website (<http://popvote.hk>)
- 2) Declares oneself to be a Hong Kong permanent resident over 18 years of age, then keys in one's HKID number in full, and a cell phone number which can be used to send SMS
- 3) The intending voter must then send a blank or worded SMS within one minute using one's registered cell phone to the telephone number prompted by the system
- 4) Upon receiving the blank or worded SMS, the system will open a voting interface for the person to vote. In case the person's HKID number or cell phone number has already been used, the system will not open the voting interface
- 5) The voter can choose one of the candidates or to abstain from voting under his/her own will within 3 minutes and then send out the e-voting form

Data protection measures:

- 1) The HKID number in full will then be converted by the system into a chain of irreversible Hash Codes for storage, in order to protect one's privacy, and to prevent repeated voting
- 2) The website has obtained the Hong Kong Post e-Cert in order to prevent from being counterfeited and will ensure the data is encrypted while processing
- 3) The system of the registration computer will be equipped with a virtual keyboard to prevent data from being stolen
- 4) Since no data will be stored in the computer, if one left the voting interface before completing the voting process, the intending voter will have to repeat all steps
- 5) All processed data will be stored in the central server, the computer will not store any individuals' data

#### Smartphone App Voting

The voting time and process will be the same as the offsite e-polling but for those using Smartphone App voting must download the PopVote app.

**Design of the onsite polling station**

Initial layout of the polling station:

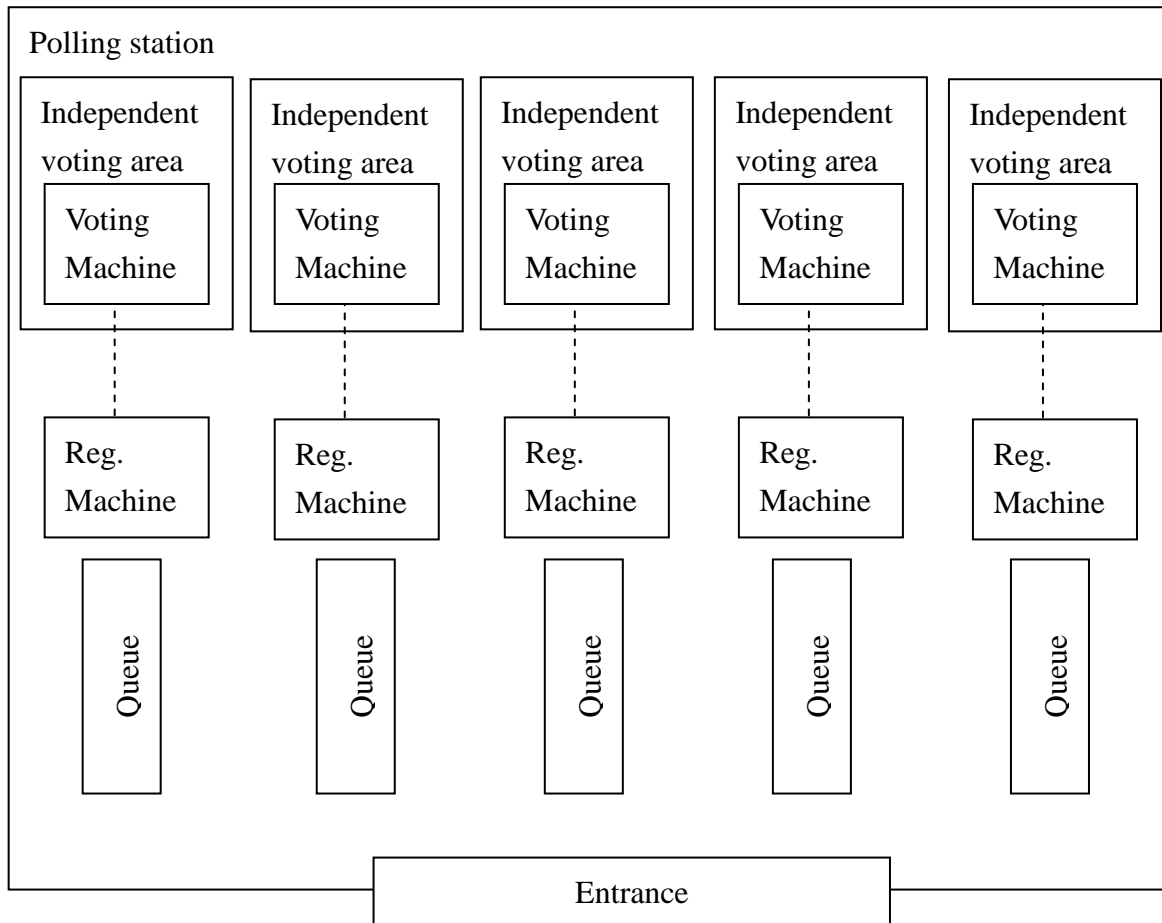

Voting time: 0900 to 2100

Number of computers: Around 10

Polling station staff: Around 12

Number of polling stations and venue: tbc

Information for verification: Identity Card

## Onsite e-polling Process

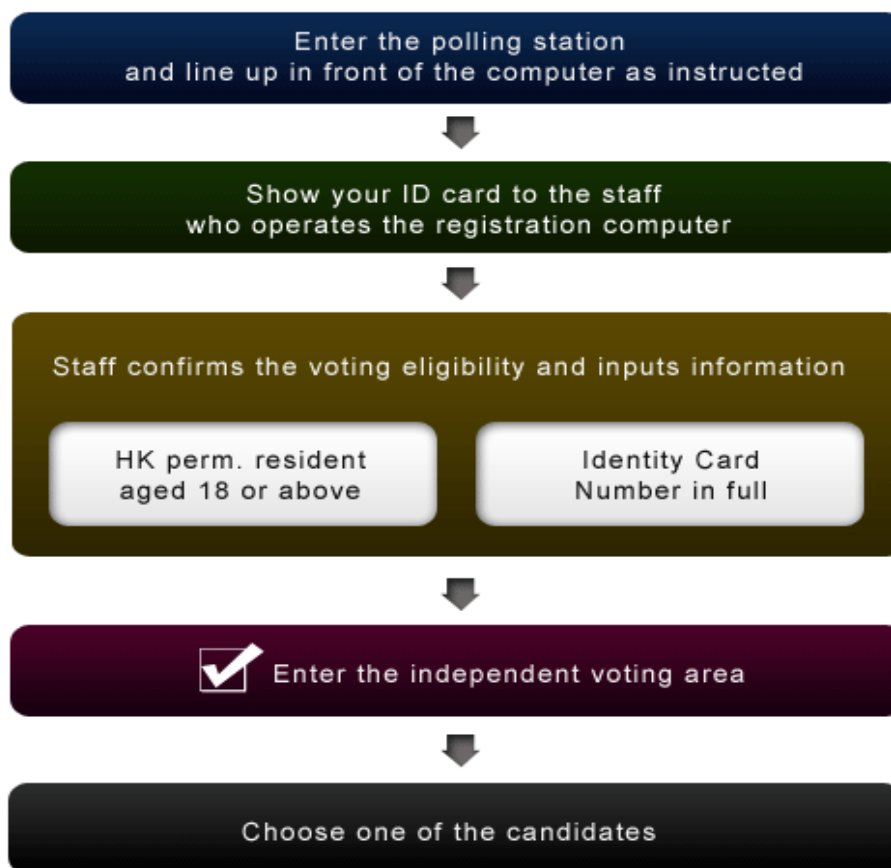

### Voting Procedures :

- 1) Enter the polling station and line up in front of the computer as instructed
- 2) Show your ID card to the staff who operates the registration computer
- 3) Staff confirms the voting eligibility and inputs the Identity Card Number in full and then arranges the voter to designated independent voting area
- 4) After entering the voting area, the voting computer will be automatically switched on without requesting to input any personal information. The voter has to choose one of the candidates or to abstain from voting under his/her own will within 3 minutes and then send out the e-voting form
- 5) There will be staff near the voting area to help those who encountered problems during the voting

### Data protection measures:

- 1) High privacy independent voting area will be adopted so that voters will not be interfered while voting
- 2) Staff will only input voter's Identity Card Number into the voting system
- 3) The HKID number in full will then be converted by the system into a chain of irreversible Hash Codes for storage, in order to protect one's privacy, and to prevent repeated voting
- 4) The system of registration computer will be equipped with a virtual keyboard to prevent data from being stolen
- 5) The website has obtained the Hong Kong Post e-Cert in order to prevent from being counterfeited and will ensure the data will be encrypted while processing
- 6) All processed data will be stored in the central server, the computer will not store any individuals' data